

PLINTH AREA 819 SQ.M.
ROOF AREA 649 SQ.M.

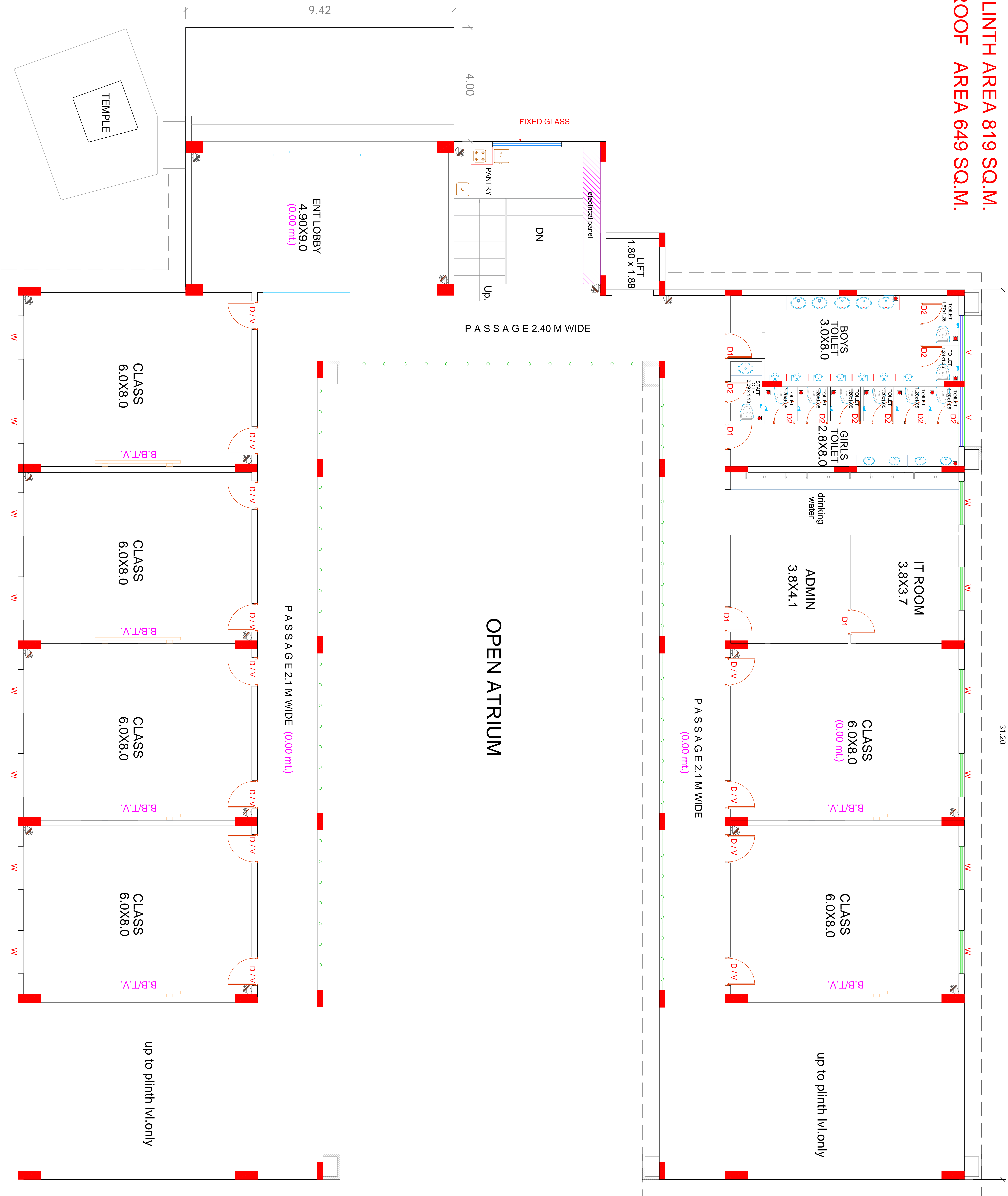

| | |
|--|-------------------|
| <div>DRG NO.</div> | <div>ARC-01</div> |
| <div>GENERAL NOTES & SPECIFICATIONS</div> | |
| <div> <p>1. ALL DIMENSIONS, UNLESS OTHERWISE STATED, ARE IN MILLIMETERS.</p> <p>2. PROVIDE ALL NECESSARY DIMENSIONS IN ANY DRAWING ARE TO BE CLARIFIED FROM AUTHORITY CONCERNED.</p> <p>3. DO NOT SCALE DRAWING, FOLLOW ONLY WRITTEN DIMENSIONS.</p> <p>4. GENERAL GRADE OF REINFORCED CONCRETE: M-25 (NOMINAL).</p> <p>5. GENERAL GRADE OF REINFORCING STEEL: Fe500 (NOMINAL).</p> <p>6. CEMENT:</p> <p> A) USE 53 GRADE O.P.C. CONFORMING TO IS-2306.</p> <p> B) USE 42.5 GRADE O.P.C. CONFORMING TO IS-2306.</p> <p>7. REINFORCING BARS:</p> <p> A) REINFORCING BARS SHALL BE IN STEEL MATERIAL, B.T. METAL M.S.A. - 30MM & DOWN FOR SLAB, SUCH THIN SECTIONS.</p> <p> B) COLUMNS 12.5 MM & DOWN FOR SLAB, SICH THIN SECTIONS.</p> <p>8. REINFORCEMENT: - HYSD BARS OF GRADE Fe500 CONFORMING TO IS-1786-1985.</p> <p>9. BARS OF 16MM OR BARS WITH FEMISSON OF STRUCTURAL DEVELOPMENT.</p> <p>10. REINFORCEMENT LAPPING LENGTH OF BARS (C-500 AND T = 550) MINIMUM CLEAR COVER TO R/F (OUTERMOST)</p> <p> FOUNDATION: 50MM (SIDE & BOTTOM & TOP)</p> <p> COLUMN: - 40MM (SIDES)</p> <p> BEAM: - 25MM (TOP & BOTTOM & TOP)</p> <p>11. CURING PERIOD FOR RCC: - 14 DAYS</p> <p>12. STRIPPING TIME OF FORM WORK FOR RCC: AS DECIDED BY SITE ENGINEER IN ACCORDANCE WITH IS-466/2000</p> <p>13. CONCRETE SHALL BE CASTED IN SINGLE LIFT ELEMENTS SHOULD BE GOT APPROVED BEFORE CASTING.</p> <p>14. ANY DISCREPANCY IN FIELD DIMENSION SHOULD BE GOT CLARIFIED FROM THE CONSULTANTS.</p> <p>15. PLEASE CHECK THE DIMENSION WITH RESPECT TO ARCHITECTURAL DRAWING.</p> <p>16. FOR OTHER GENERAL DETAILS FOLLOW IS-466/2000 OR SEEK CLARIFICATION FROM CONSULTANTS</p> <p>17. THE BUILDING FOUNDATION IS DESIGNED FOR G+4 FLOOR ONLY.</p> <p>18. THE EXCAVATED AREA OF PLINTH/FOUNDATION TO BE EXCAVATED TO THE EXISTING GROUND SURFACE.</p> <p>19. COMPACT THE SUBGRUUM TO GIVE A FIELD DENSITY OF 66.42 KG/CF3 (125MM/CC).</p> <p>24. MINIMUM SPECIFIED BEARING CAPACITY OF SOIL FOR FOUNDATION SHALL BE 250 (N/CM2) (40 TONS/CM2) AT 10 MM DEPTH</p> </div> | |

[illegible]

| | |
|--------------------------------|------------|
| GROUND FLOOR | |
| PROJECT | |
| FAITH FOUNDATION GLOBEL SCHOOL | |
| SCALE | |
| DATE | 08-12-2022 |
| DGN. BY. | Ranjana |
| CKD. BY. | J.S. |
| AREA | |
| STRUCTURAL CONSULTANT | |

A & J CONSULTANTS
CONSULTING ENGINEERS

323, KRISHNA BUSINESS CENTER, NEAR
MENDANTA HOSPITAL, RASOMA SQUARE
INDORE (M.P.), PH. : (0731) 2971677
e-mail : arjavarst@gmail.com
www.jsaconsultant.com